



 **smith&nephew**
LEGION[®]
Total Knee System

System flexibility

Flexibility

Today's knee implant patients present increasingly diverse scenarios. The versatility of the LEGION® Total Knee System allows surgeons to simplify decision making intraoperatively and deliver personalized joint care no matter the patient indications.

CR to PS

- Easily convert to PS through femoral trial
- PS box preserves anterior bone bridge

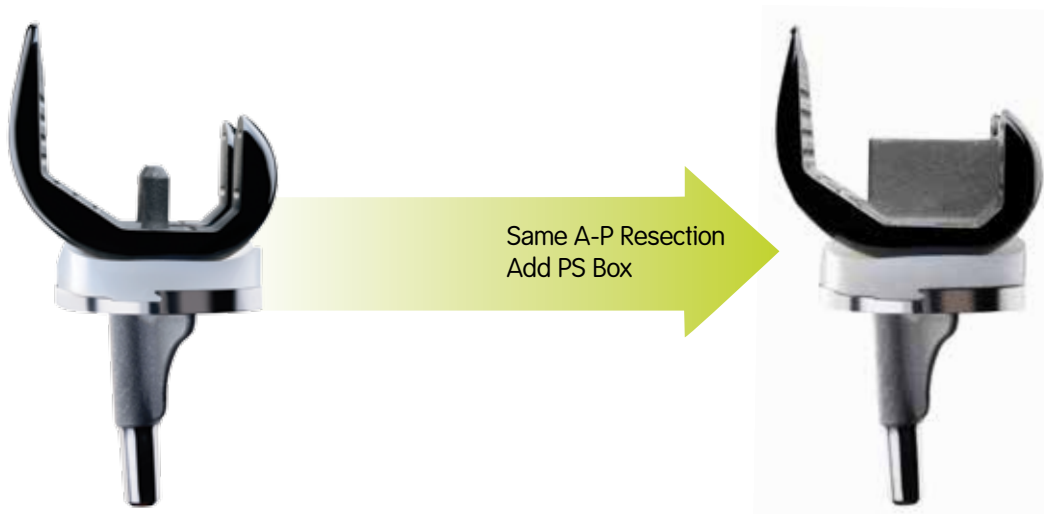

PS to PS Augmented

- Quickly adjust for femoral defects

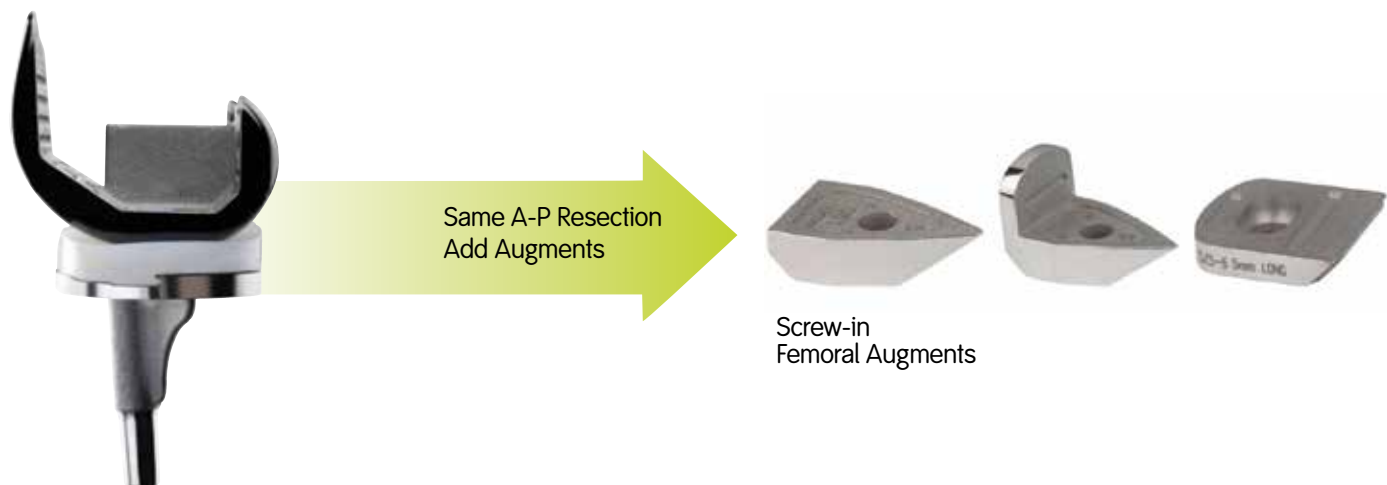

PS to PS Constrained

- Add a constrained insert without using a stem, on the femur, if desired

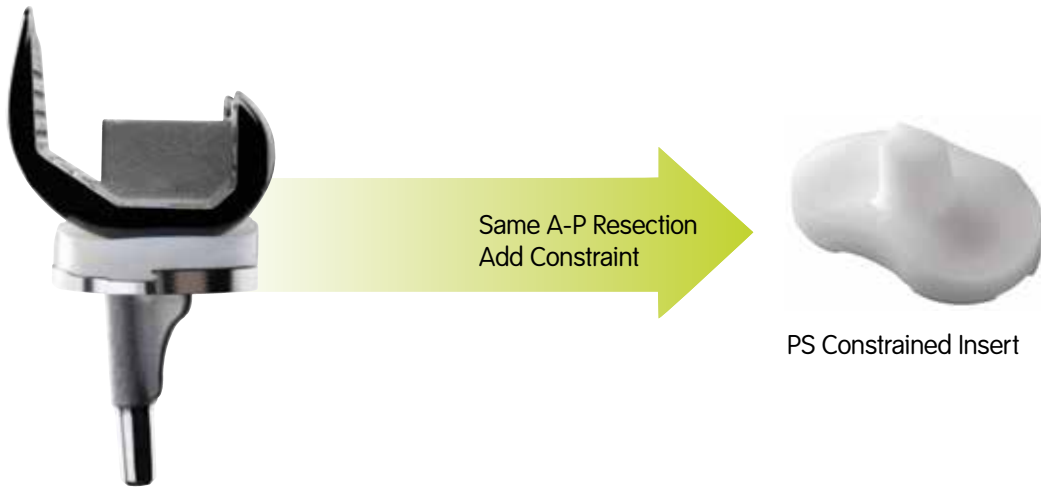

Primary to Revision to Hinge

- Converting a knee from Revision to Hinge requires only two additional trays and three steps

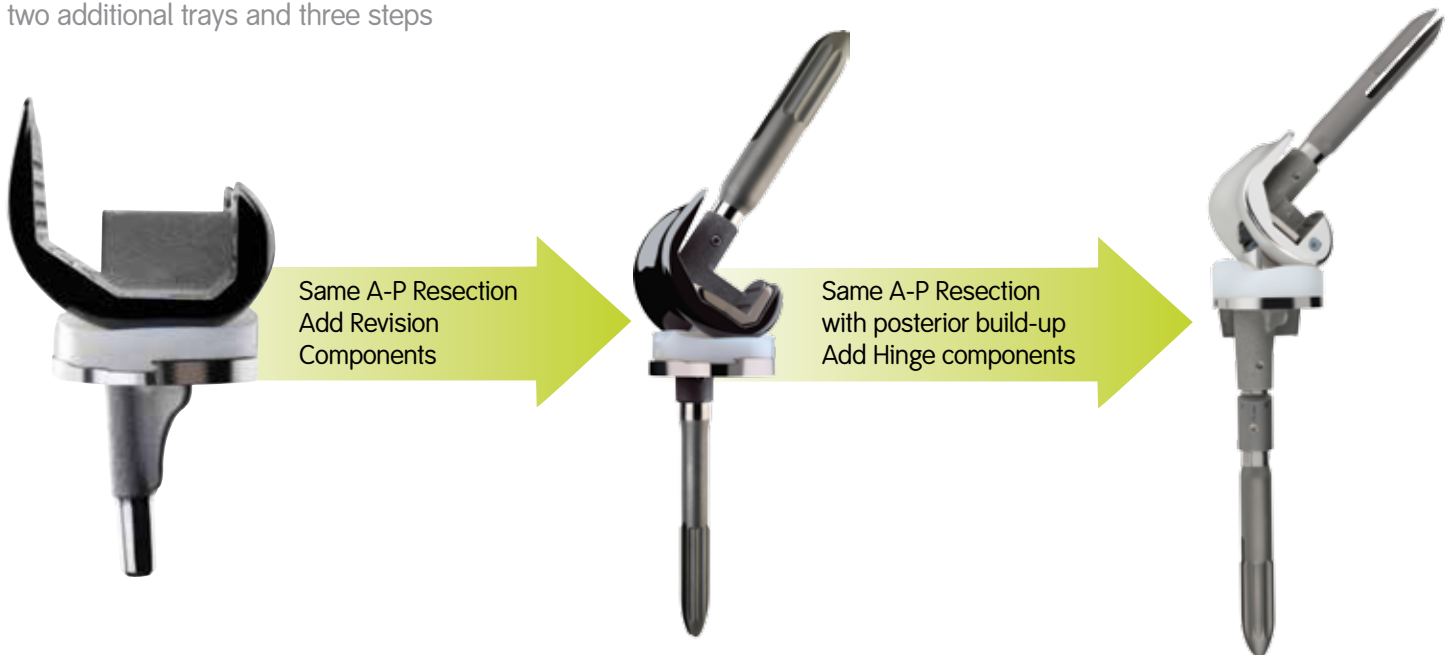

Femoral options

All femoral components are available in OXINIUM® material or cobalt chrome



Cruciate Retaining (CR)
Porous (CoCr only)



Cruciate Retaining (CR)



Posterior Stabilized (PS)



Revision Knee (RK)



Hinged Knee (HK)

Inserts

The LEGION® TKS high flexion inserts have been tested to provide up to 155° range of motion and are available in CPE and XLPE. Constraint may be dialed in from Cruciate Retaining up to 2 – 3° of varus/valgus constraint.³



Cruciate Retaining (CR)



Deep Dished (DD)



Cruciate Retaining High Flex (CRHF)



Posterior Stabilized High Flex (PSHF)



Posterior Stabilized (PS)



Posterior Stabilized Constrained (PSCon)*



Hinged Guided Motion (HK)*

*Not available in XLPE.

Tibial base plates

Achieve maximum coverage while maintaining proper axial alignment with the asymmetric tibial base plates. The primary and revision designs are engineered with the same locking mechanism. The Hinged (HK) design maintains the same anatomic footprint while using a locking screw.



All-polyethylene*



Primary



Revision



Hinged

Patellas

Round Resurfacing available in 9 and 7.5mm thicknesses



Oval Resurfacing



Round Resurfacing



Biconvex*

*Not available in XLPE.

Instrument setup options

Surgeons have the FLEXIBILITY to choose their preference in surgical setup ranging from a standard instrument setup to a VISIONAIRE® FastPak solution which greatly reduces the amount of instrumentation needed.

Standard instruments

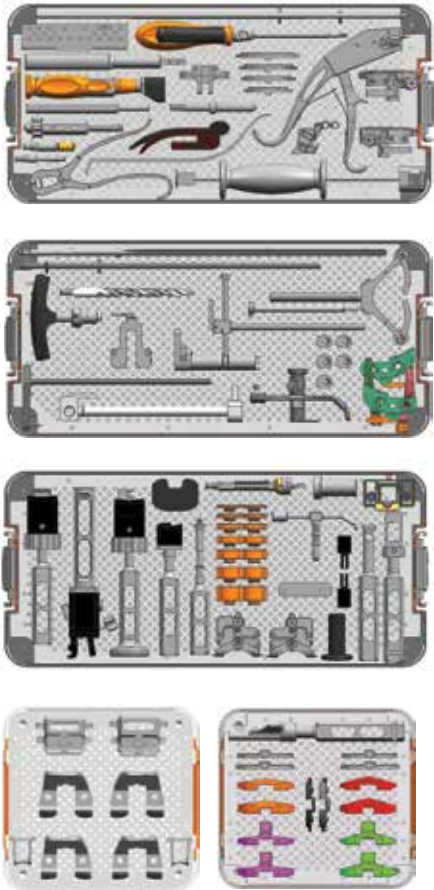

Modular sizing trays allow for reduced standard instrumentation

VISIONAIRE Cutting Guides



Patient matched Cutting Guides reduce instrument trays by >43%¹

VISIONAIRE FastPak Instruments



VISIONAIRE FastPak Single Use Instrumentation reduces instrument tray needs by 57%²

References

1. Noble, J; To compare the value of VISIONAIRE to that of standard TKA instrumentation in terms of mechanical axis alignment and cost efficiencies. JOA, 2012;
2. Patient-Specific Versus Conventional Instrumentation for Total Knee Arthroplasty: Peri-Operative and Cost Differences; J Arthroplasty (2014) DeHaan AM, Huff, TW, et al
3. Smith & Nephew Internal document #40420508 7128-1283 02/05



Smith & Nephew, Inc
1450 Brooks Road
Memphis, TN 38116
USA

www.smith-nephew.com
www.legionpower.com

Telephone: 1-901-396-2121
Information: 1-800-821-5700
Orders and Inquiries: 1-800-238-7538

*Trademark of Smith & Nephew. Registered US Patent and Trademark Office.

©2015 Smith & Nephew
03113 V2 04/15